



**Anglemont
Zoning Bylaw No. 650
Schedule B Zoning Maps**

**Ross Creek
F 2611**

- Zoning Boundary
 - Parcel Boundary
 - CSRD Mapsheets
 - Rivers & Streams
 - Lake
- CG-2 - Commercial General
 - RS-1 - Residential
 - RS-5 - Residential
 - RM-2 - Residential
 - CR - Country Residential
 - CD1 - Comprehensive Development
 - RR-60 - Rural Residential Large
 - RR-4 - Rural Residential Small
 - AR1 - Agriculture 1 (20 ha)
 - AR2 - Agriculture 2 (4 ha)
 - P-4 - Recreation

Anglemont Zoning Bylaw No. 650
Adopted February 19, 1998
Bylaw No.650-6 August 16, 2012

Consolidated for Convenience
Only with Bylaw 650-6

CSRD Mapsheets

2710	2711	2712
2610	2611	2612
2510		

Mapsheet 2611

Nad 83 CNT Datum
UTM Zone 11 Projection

0 100 200 300m

Scale 1:10,000

Prepared by: GIS Department Staff
Columbia Shuswap Regional District
781 Marine Park Dr NE, Salmon Arm, BC V1E 4P1
Date: 2012-Sep-12
File: Mapbook_Zoning_AreaF_650_Anglemont_11x17

The information on this map was compiled by the CSRD for regulatory and internal reference purposes only. No representation or warranty is made as to the accuracy of information.

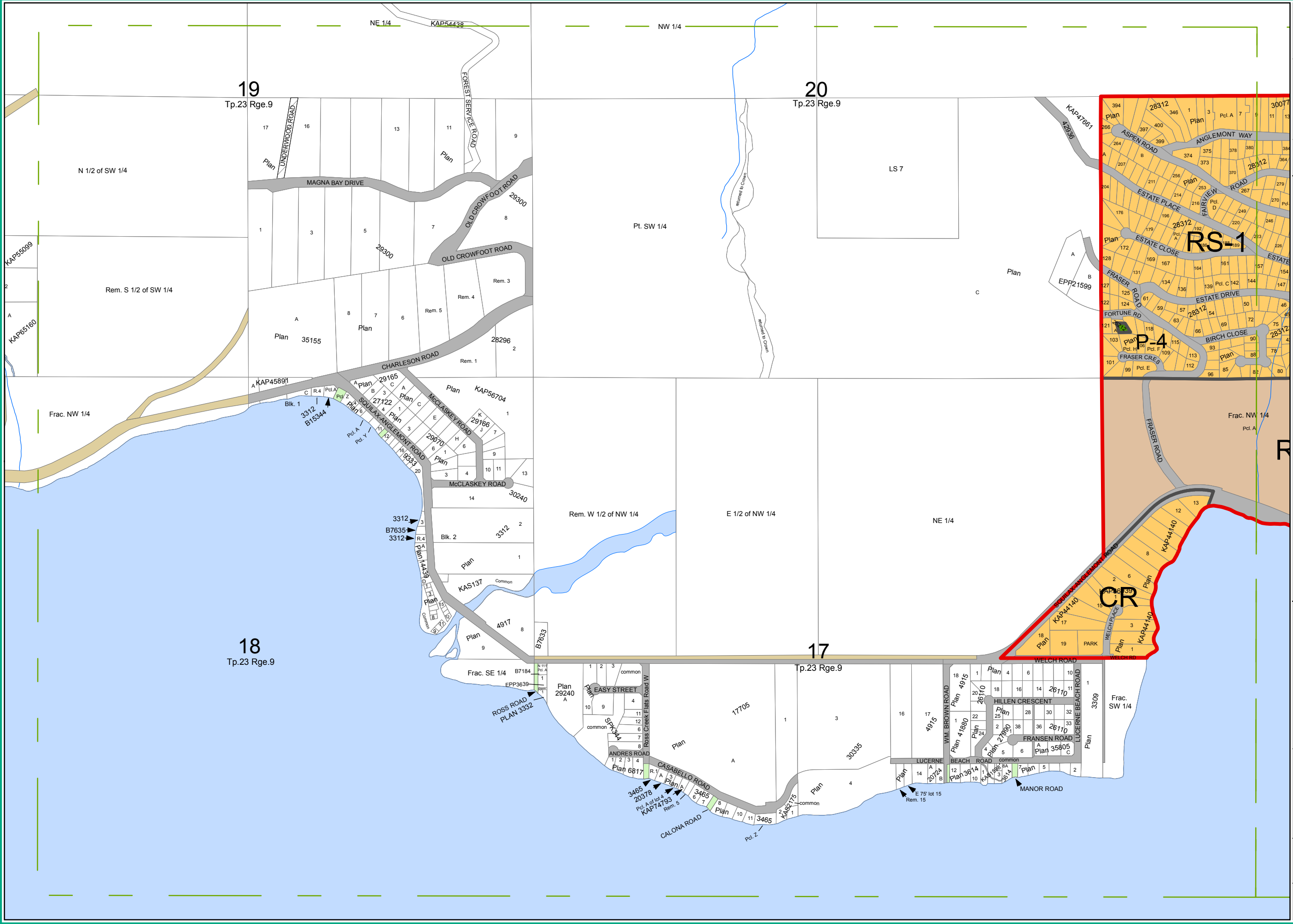

Zoning Bylaw 650 -- F -- Ross Creek
2611



**Anglemont
Zoning Bylaw No. 650
Schedule B Zoning Maps**

Anglemont
F 2612

- Zoning Boundary
- Parcel Boundary
- CSRD Mapsheets
- Rivers & Streams
- Lake
- CG-2 - Commercial General
- RS-1 - Residential
- RS-5 - Residential
- RM-2 - Residential
- CR - Country Residential
- CD1 - Comprehensive Development
- RR-60 - Rural Residential Large
- RR-4 - Rural Residential Small
- AR1 - Agriculture 1 (20 ha)
- AR2 - Agriculture 2 (4 ha)
- P-4 - Recreation

Anglemont Zoning Bylaw No. 650
Adopted February 19, 1998
Bylaw No.650-6 August 16, 2012

Consolidated for Convenience
Only with Bylaw 650-6

CSRD Mapsheets

2711	2712	2713
2611	2612	2613

Mapsheet 2612

Nad 83 CNT Datum
UTM Zone 11 Projection



Scale 1:10,000

Prepared by: GIS Department Staff
Columbia Shuswap Regional District
781 Marine Park Dr NE, Salmon Arm, BC V1E 4P1
Date: 2012-Sep-12
File: Mapbook_Zoning_AreaF_650_Anglemont_11x17

The information on this map was compiled by the CSRD for regulatory and internal reference purposes only. No representation or warranty is made as to the accuracy of information.

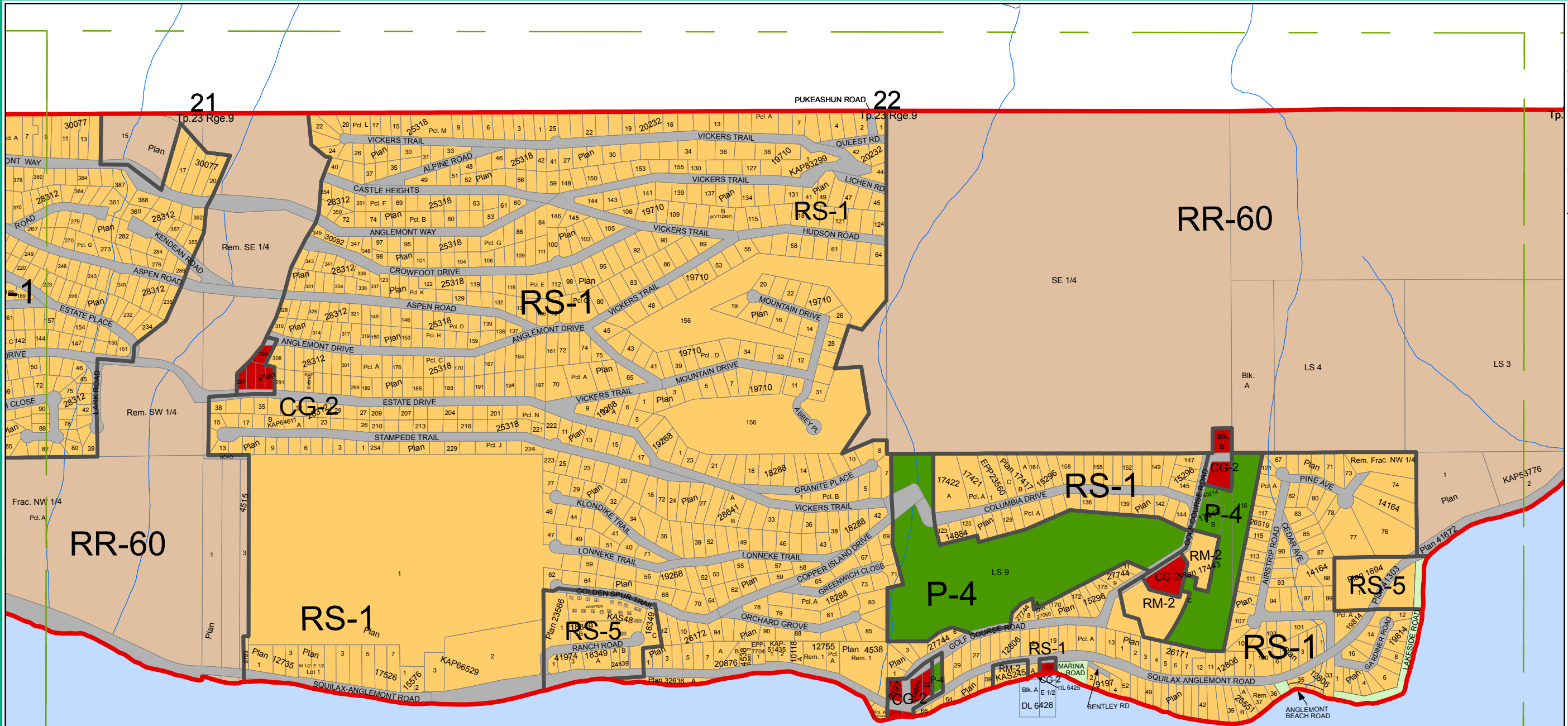

16
Tp.23 Rge.9

15
Tp.23 Rge.9

22
Tp.23 Rge.9

21
Tp.23 Rge.9

Zoning Bylaw 650 -- F -- Anglemont
2612



Anglemont Zoning Bylaw No. 650

Schedule B Zoning Maps

Armstrong Point F 2613

- Zoning Boundary
- Parcel Boundary
- CSR Mapsheets
- Rivers & Streams
- Lake

- CG-2 - Commercial General
- RS-1 - Residential
- RS-5 - Residential
- RM-2 - Residential
- CR - Country Residential
- CD1 - Comprehensive Development
- RR-60 - Rural Residential Large
- RR-4 - Rural Residential Small
- AR1 - Agriculture 1 (20 ha)
- AR2 - Agriculture 2 (4 ha)
- P-4 - Recreation

Anglemont Zoning Bylaw No. 650
 Adopted February 19, 1998
 Bylaw No.650-6 August 16, 2012

Consolidated for Convenience
 Only with Bylaw 650-6

CSR Mapsheets

2712	2713	2714
2612	2613	2614

Mapsheet 2613

Nad 83 CNT Datum
 UTM Zone 11 Projection

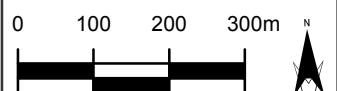

Scale 1:10,000

Prepared by: GIS Department Staff
 Columbia Shuswap Regional District
 781 Marine Park Dr NE, Salmon Arm, BC V1E 4P1
 Date: 2012-Sep-12
 File: Mapbook_Zoning_AreaF_650_Anglemont_11x17

The information on this map was compiled by the CSR for regulatory and internal reference purposes only. No representation or warranty is made as to the accuracy of information.

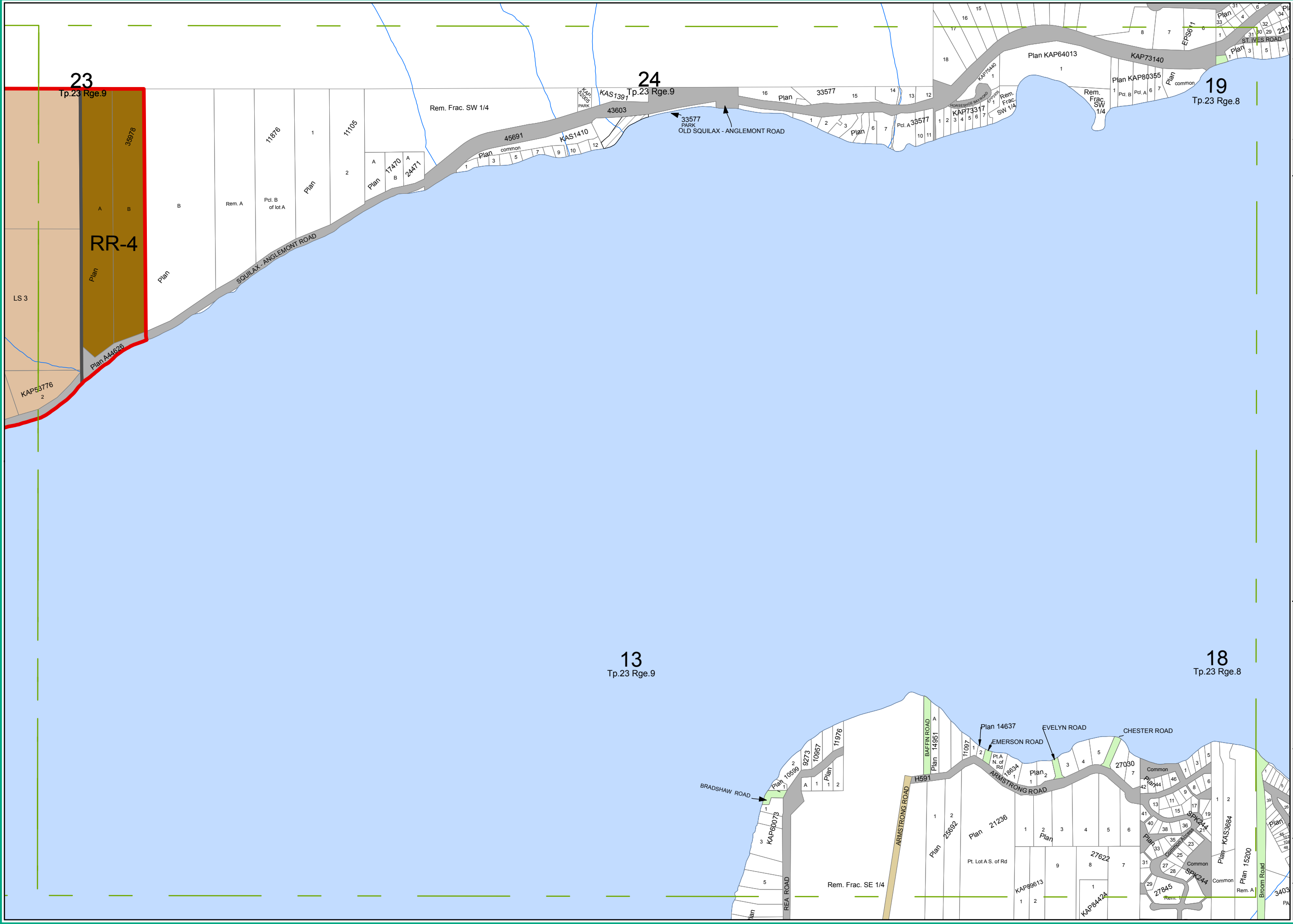

Zoning Bylaw 650 -- F -- Armstrong Point 2613