

5.5 REVELSTOKE ADVENTURE PARK – GREELEY – DEVELOPMENT PERMIT GUIDELINES

BL850-11

- 5.5.1 The purpose of this section is to designate Development Areas for the Revelstoke Adventure Park in Greeley
- 5.5.2 The area designated under the Development Permit Areas is shown as Figure 5.5.2.1, as follows

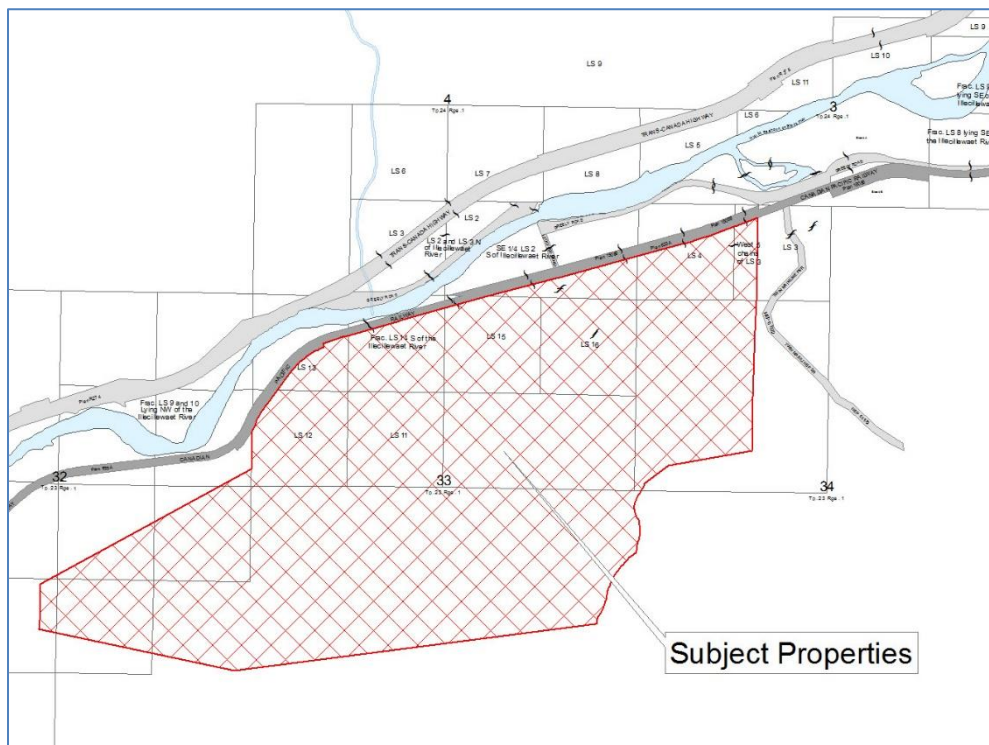

Figure 5.5.2.1 Revelstoke Adventure Park - Greeley

5.5.3 Greeley Environmental Development Permit Area 1

5.5.3.1 Designation

The Greeley Environmental Development Permit Area 1 (GEDP1) is designated under Section 488(1)(a) of the Local Government Act and applicable provisions of the Community Charter for the protection of the natural environment, its ecosystems and biological diversity.

5.5.3.2 Justification

The goal of the GEDP1 is to prevent and mitigate potential negative impacts on the natural environment from commercial development and recreational activities as outlined in the Guidelines below.